

Coloneum Stage 36

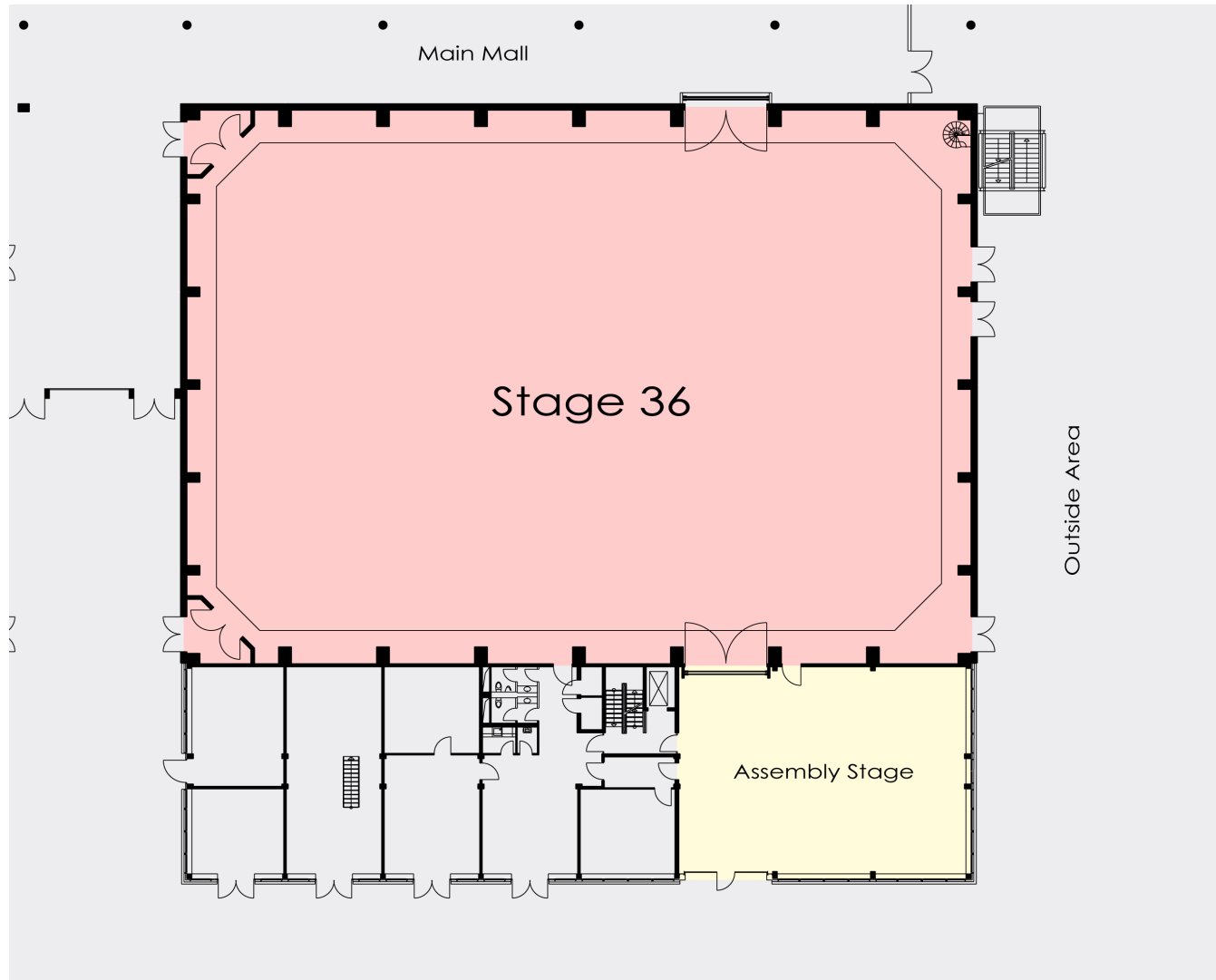

Dimensions

| | |
|------------|---|
| Length | 157.47 ft (48.00 m) |
| Width | 111.15 ft (33.88 m) |
| Total Area | 17,502.79 sq ft (1,581.40 m ²) |

Operating Area

| | |
|------------|---|
| Length | 144.35 ft (44.00 m) |
| Width | 96.71 ft (29.48 m) |
| Total Area | 13,960.09 sq ft (1,297.12 m ²) |

Height

| | |
|-------------------|-----------------------|
| Height to Ceiling | 36.09 ft (11.00 m) |
| Height to Grid | 35.10 ft (10.70 m) |

